

# XCONNECT

**SPRINTUS**

# FLOORY L XC

Clean work,  
smart vacuuming



## Intelligent automatic start/stop. Simple. Clean. Safe.

With the innovative Xconnect appliance control system, nothing stands in the way of automatic start/stop when working with cordless tools! It saves a considerable amount of time, as the extraction of fine dust from the power tool starts automatically as soon as the cordless tool starts working. This means that in future it will not only be possible to automatically extract dust from corded tools, but also from cordless tools with machines from any manufacturer. The intelligent transmitter is attached to the power tool and detects whether it is switched on or off. The transmitter transmits the signal wirelessly to the radio-controlled socket. This activates the vacuum cleaner – for a dust-free working environment and maximum health protection. The radio-controlled socket can be controlled by up to three different transmitters.

Technical Data:	
Operating range	max. 30 m
Frequency band	2.400-2.483 MHz
Ambient temperature	0°C to +35°C
Storage temperature	-30°C bis +70°C
Protection class	IP44
Radio-controlled socket outlet	
Power supply	230 V~
Switching cable max	3600 W
Transmitter	
Power supply	1x CR2032 battery



Your perfect construction site companion: the set consisting of the Floory in dustclass L dry vacuum cleaner, Xconnect automatic start/stop and rubber sleeve makes dust-free working easier than ever. The compact vacuum cleaner impresses with its high suction power, quiet operation and low weight. Thanks to the intelligent Xconnect automatic system, suction starts as soon as the power tool is switched on – for greater speed and health protection. With the universal rubber sleeve, the Floory XC L can be connected to any power tool – ideal for electricians, carpenters or trade fair constructors.

	Item-No.	EU
FLOORY L XC		114077
Standard accessories:		
Xconnect Set		118342
Power tool adapter		101025
Suction tube 0,5 m, aluminum		106026
Suction hose, 3m, electrically conductive		120141
Hard floor nozzle 360 mm		111202
Crevice nozzle 220 mm		101023
Round nozzle		101024
HEPA 13 Fleece filter bag (1 pcs)		
HEPA 13 Fleece filter basket		114118
Power cord 10 m, pluggable, black		111128
Optional accessories:		
Fleece filter bag (10 pcs)		106013
Fleece filter bag (250 pcs)		106014
HEPA 13 Fleece filter bag (10 pcs)		106061
Suction hose complete, 2,5 m		114113
Telescopic suction tube 0,6 - 1,0 m, stainless steel		117228
Suction hose, 2,5 m, antistatic		109111

## Highlights

- ▶ **Universal application**  
For cordless and corded tools, compatible with all manufacturers
- ▶ **Reliable connection**  
Stable radio control – up to 30 m – without Wi-Fi, without cloud
- ▶ **Automatic vacuum cleaner activation and deactivation**  
Starts/stops the vacuum cleaner when the tool is switched on/off
- ▶ **Quick retrofitting**  
Plug-and-play: no conversion, ready for use in a few minutes
- ▶ **High flexibility**  
One receiver can be controlled with up to 3 transmitters
- ▶ **Protects health**  
Efficient dust minimisation throughout the entire work process
- ▶ **Sustainable & cost-efficient**  
No need to purchase a new vacuum cleaner or tool
- ▶ **Ready for immediate use**  
No need to activate the transmitter after a long break
- ▶ **Reliable sensor technology**  
Sensitive sensor technology for very weak vibrations & special sensor technology for reliable switching even with large machines with strong vibrations

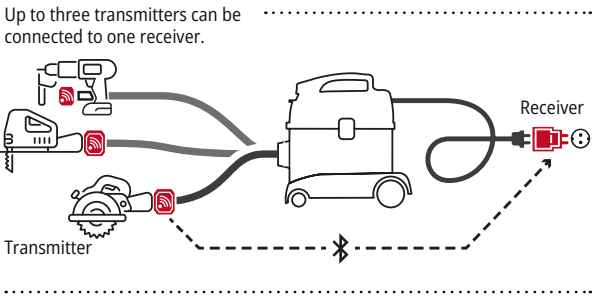

Xconnect Set: Receiver EU, Transmitter & replacement strap

	Item-No.	UK	EU
Xconnect Set		*	118342
Standard accessories:			
Xconnect Receiver		*	118340
Xconnect transmitter (incl. replacement strap)			118341
Xconnect replacement strap			118343

\*on request